

QTY: 3 REF: 7018 Pedestrian diversion sign-Left	
QTY: 2 REF: 7010-1 Nature of temporary hazard ahead - Footpath Closed	
QTY: 4 REF: 7001 Road works ahead	
QTY: 3 REF: 7018 Pedestrian diversion sign-Right	

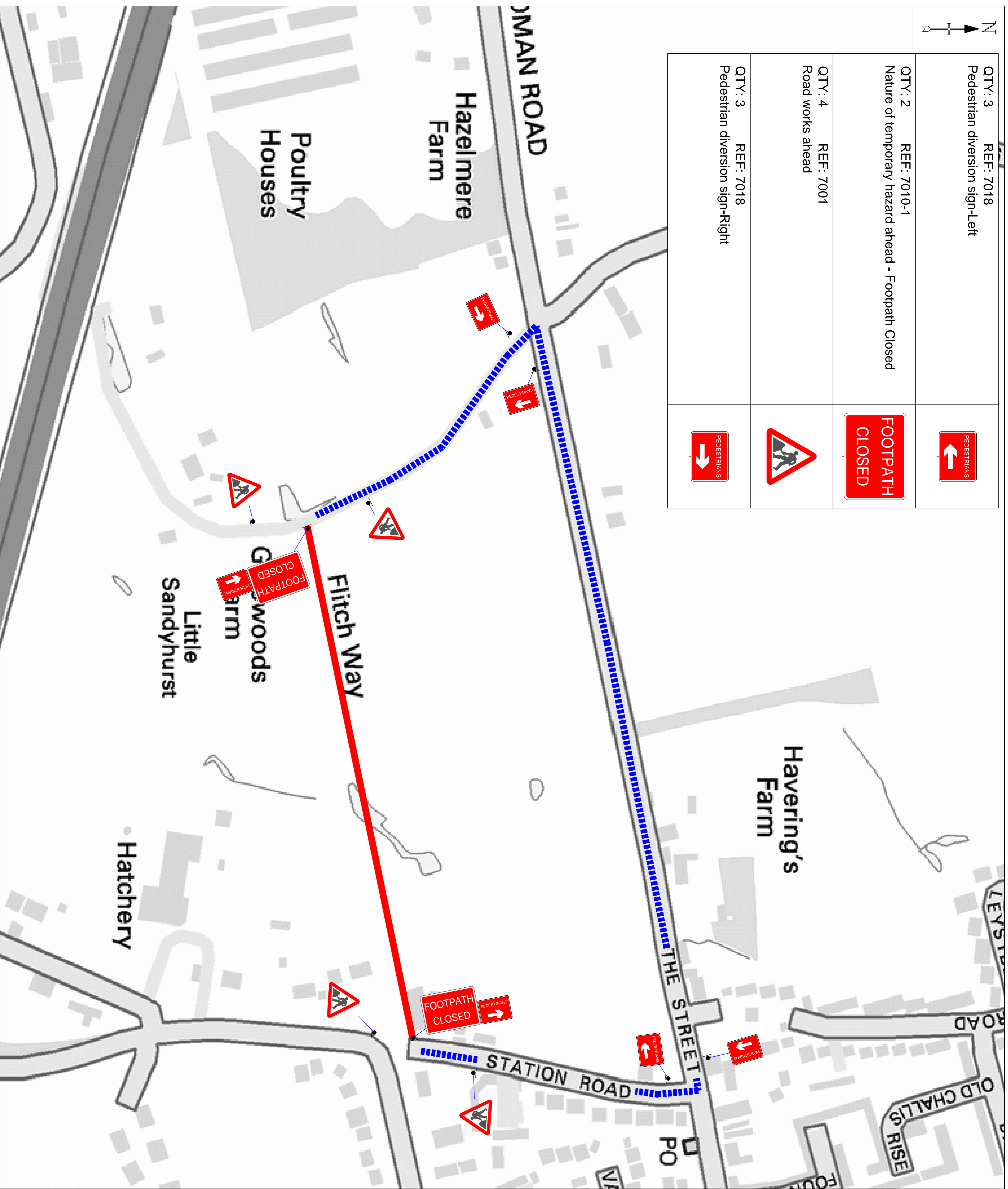

Client

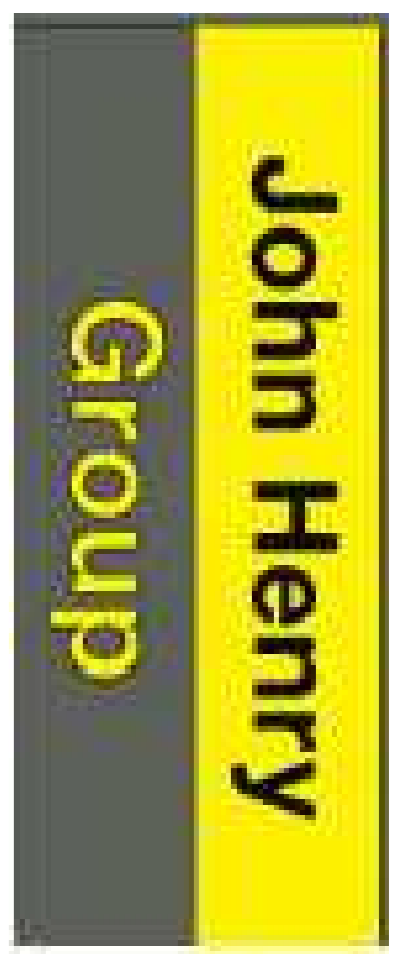

working in partnership
with



AVANTI TRAFFIC MANAGEMENT LTD.
THE SIDINGS, STATION ROAD,
LONGSTANTON, CAMBRIDGE, CB24 3DS
01954 262819 (t) 01954 288015 (f)
www.avantitrafic.co.uk

Key

	Sign Symbol
	Cone
	Traffic Light Symbol
	Stop / Go Symbol
	Works Area
	Stop / Go
	Traffic Light
	Pedestrian Barrier
	Diversion Route
	Road Closure Works Area
	Cut Line
	Traffic Light Phase
	Block Board

Cross Section

Lane 2 Closure or Shuttle Lane

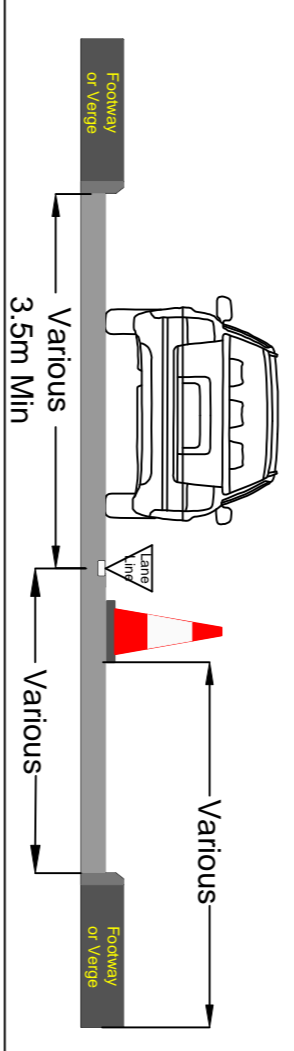

Works Location

STATION ROAD, THE FLITCH WAY, BRAINTREE, CM77 6RN

Traffic Management Type

FOOTPATH CLOSURE

Notes

USRN: 81401666

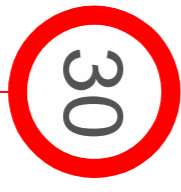

SAFETY ZONES/SAFETY ZONE	
0.5M	0.5M

Ordnance Survey © Crown Copyright 2012. All rights reserved. Licence Number 100020449

Originator	Designer	Checked	Approved
JHG	MB	PM	AQ

Scale	Date
NOT TO SCALE	JANUARY 2019

Revision	Drawing Number
P1	AVT/11319/MB/01